



2018 NATIONAL DOG SHOW

PORIRUA | 4-6 OCTOBER | PROSSER ST

Reporting sheet

ACCESS TO VENUE: Gates open from 6am daily with access to the building with exhibitor pass. There may be limited parking available at \$10 per park.

BREED AND GROUP JUDGING: It is the exhibitor's responsibility to present their dog(s) for judging. Only three calls will be given after which time a dog will be deemed absent. One handler per dog is required in the assembly area. There will be times when two Groups are being judged at the same time and due to time constraints we will not be able to reschedule timings. Exhibitors are advised to arrange an alternative handler in the case of any potential clashes.

CATERING: Full catering available.

CAMPERS AND PARKING: Exhibitors with parking will be contacted separately. Enquiries to ndsparking@dogsnz.org.nz

CRATES TROLLEYS AND TABLES: Trolleys will only be allowed in the holding ring where exhibitors have multiple entries (more than two dogs). These must be removed immediately after showing and before the next breed commences. Your co-operation is requested or this privilege will be withdrawn. The rule of one dog one handler still applies. If you have dogs entered in consecutive classes you must organise the next dog ready for exhibition. Dogs must be kept in their trolley when not being exhibited.

CHALLENGE CERTIFICATES: These will be available from the Dogs New Zealand stand after breed judging.

CATALOGUES: Pre-ordered catalogues can be collected from the Dogs New Zealand stand from Thursday 4 October. Catalogues can be purchased throughout the event for \$15.00 (Full catalogue), \$2.00 (Group catalogue) and \$5.00 (Obedience catalogue).

CRUFTS QUALIFYING CERTIFICATES: The 2018 BlackHawk National Dog Show is one of the Overseas Qualifying Shows for Crufts. The Junior Dog, Junior Bitch, Best Dog and Best Bitch of each breed qualify to compete at one of the world's top events. Certificates can be ordered at the Dogs New Zealand stand during the show at a cost of \$15.00.

DRESS AND BEHAVIOUR: We know that as exhibitors, you will recognise this is our premier event and display a high standard of sportsmanship, dress and behaviour to match the occasion. Dress for Best in Show will be formal.

DOGS ON GRANDSTANDS: Exhibitors are reminded that the grandstands are for people only. No dogs are allowed on the stands.

FOULING: The building is a NO FOULING area. All faecal deposits and urination must be cleaned up immediately inside and outside of the building, including doorways. There will be two poop bag dispensers. These will be located on the east and west boundary fences.

GROOMING INFORMATION: Grooming has been allocated as per the bookings received online. All Grooming is located in the side hall. 1.5metre square spaces were sold as AM and PM time slots for Thursday and Friday and full days for Saturday and the CSK show on Sunday.

A grooming plan has been uploaded on the website and will be displayed at the venue during the event.

To check your grooming space visit...
<https://nds2018.dogsnz.org.nz/grooming.html>

LUCKY DRAW: Be at the home of Dogs NZ, to be in to win a refund of all NDS entry and grooming fees. There will be 7 lucky draws, one in each group. See nds2018.dogsnz.org.nz for full details of how to enter. You will find your lucky draw number in this envelope - bring this to the admin desk prior to breed judging on the day you are showing.

MOBILITY PARKING: Mobility Parking is available on a first come basis. You must display your card. If mobility parking has not been pre-booked, it may not be available. Enquiries to ndsparking@dogsnz.org.nz

OVERSEAS VISITORS: Any exhibitor who has an overseas visitor with them or knows of an overseas visitor attending the show, please make this known to the Show Manager, Steve Tate who will ensure that they are welcomed and offered our hospitality. Please go to the Dogs NZ Admin desk on arrival.

PASSES, GOODY VOUCHERS AND NUMBERS: Posted 13 September 2018.

PHOTOGRAPHS: All In Show winners will be required to remain at the conclusion of the show for photographs. All BEST OF BREED winners will be required to proceed to the photography stall for a photograph immediately after the award is made. All Group Class Award Winners will be required for photographs with the judge at the conclusion of Group Judging. Photographs for Obedience winners will take place at the prize giving for each event.

PRINTED RESULTS: Printed results for each breed will be available from the Dogs NZ stand one hour after completion of breed judging for \$2.00 per page.

RALLY-O: Will be held at the completion of Obedience each day.

RESPONSIBLE BEHAVIOUR: All people are asked to observe a high standard of behaviour, to act courteously to others, and to follow the reasonable instructions of the event officials. Dogs New Zealand (Dogs NZ) reserves the right to exclude from the show any person/s in breach.

SECURITY OF VALUABLES: Please ensure your vehicles are secured and under your control at all times. Do not leave valuables in the grooming area. Dogs NZ takes no responsibility for the security of exhibitors' property.

SPONSORS GIFT BAGS: Please bring your gift bag voucher to the Black Hawk stand in the main arena to redeem it.

STAKES CLASSES: Stakes will be judged at 8.00am each day, on the same day that the breed is being judged for the breed class. Judging order is Veteran, then NZ Bred Stakes, then Puppy Stakes



THURSDAY JUDGING

Lucky draw (approx 9.45am) - refer nds2018@dogsnz.org.nz for full information

RING 1	
8.00am start	
Stakes	
Judge - Lesley Chalmers	
Veteran	9
NZ Bred	28
Puppy Stakes	36
10am start	
Utility	
Judge - Dirk Spruyt	
Siberian Husky	22
Boxer	12
Bullmastiff	8
Dobermann	12
Dogue De Bordeaux	3
Leonberger	4
Mastiff	3
Newfoundland	3
Rottweiler	8
Tibetan Mastiff	1
Italian Corso	3
Saint Bernard	9
Schnauzer (Giant)	2
Schnauzer (Miniature)	2
Bernese Mountain Dog	8
Shiba Inu	3
Portugese Water Dog	2
	105
	123
Not before 2pm	
UTILITY GROUP JUDGING	
Approx 3.30pm	
Junior Dog Showing (All age groups) Order TBA on the day	

RING 2	
10am start	
Terriers	
Judge - Hiroshi Kamisato	
Airedale Terrier	1
American Staffordshire Terrier	6
Australian Terrier	5
Border Terrier	26
Bull Terrier	1
Bull Terrier (Miniature)	1
Cairn Terrier	7
Fox Terrier (Smooth)	1
Fox Terrier (Wire)	3
Norwich Terrier	3
Jack Russell Terrier	7
Kerry Blue Terrier	1
Lakeland Terrier	4
Scottish Terrier	5
Staffordshire Bull Terrier	15
Manchester Terrier	1
	87
Not before 1.30pm	
TERRIER GROUP JUDGING	
Approx 2.30pm start	
Non-Sporting	
Chow Chow	5
Japanese Spitz	2
German Spitz (Mittel)	2
German Spitz (Klein)	1
Keeshond	3
Dalmatian	8
Bulldog	14
French Bulldog	23
	58

RING 3	
10am start	
Utility	
Judge - Frances Smith-Moffat	
Alaskan Malamute	4
Samoyed	14
	18
Followed by	
Hounds	
Afghan Hound	2
Beagle	5
Basenji	4
Dachshund (Min.Smooth Haired)	12
Dachshund (Long Haired)	2
Dachshund (Smooth Haired)	1
Dachshund (Min.Long Haired)	9
Dachshund (Min. Wire Haired)	4
Dachshund (Wire Haired)	1
Basset Fauve De Bretagne	1
Petit Basset Griffon Vendeen	1
Finnish Spitz	4
Foxhound	1
Rhodesian Ridgeback	6
Borzoi	3
Saluki	1
Whippet	14
	71
Not before 1.30pm	
HOUND GROUP JUDGING	
Approx 3.00pm start	
Paws n Music - Elementary HTM	
Paws n Music - Elementary Free	

RING 4	
Obedience	
Special Beginners	SB1-SB14
Novice	N1 - N32
Rally-O Novice A	NA1 - NA6
Rally-O Novice B	NB1 - NB10
Rally-O Advanced A	AA1 - AA8



UD	
Wednesday (TBA)	
Utility Dog	UD1 - UD5

FRIDAY JUDGING

Lucky draw (approx 8.45am) - refer nds2018@dogsnz.org.nz for full information

RING 1	
8.00am start	
Stakes	
Judge - Lesley Chalmers	
Veteran	4
NZ Bred	18
Puppy Stakes	29
RING 1	
9.15am start	
Non-Sporting	
Judge - Dirk Spruyt	
Boston Terrier	7
Great Dane	4
Lhasa Apso	2
Poodle (Minature)	10
Poodle (Standard)	4
Poodle (Toy)	5
Schipperke	6
Shih Tzu	3
Tibetan Spaniel	15
Tibetan Terrier	1
	57
	115
Not before 10.45am	
NON-SPORTING GROUP JUDGING	
Approx 1.30pm start	
Working Dogs	
Australian Cattle Dog	1
Australian Shepherd	6
Border Collie	7
Bouvier Des Flandres	5
Bearded Collie	6
Collie (Rough)	6
German Shepherd Dog (Stock Coat)	9
White Swiss Shepherd Dog	1
Pyrenean Sheepdog - Long Haired	1
Belgian Shepherd (Groenendael)	2
Belgian Shepherd (Malinois)	2
Belgian Shepherd (Tervueren)	5
Old English Sheepdog	1
	52
Paws n Music - Groups, Open HTM, Open Free (Approx 3.15pm start)	
Junior Dog Training Control Class (5pm)	

RING 2	
9.15am start	
Gundogs	
Judge - Hiroshi Kamisato	
Cocker Spaniel	14
Welsh Springer Spaniel	8
English Setter	1
Flat-Coated Retriever	1
German Shorthaired Pointer	7
Italian Spinone	1
Golden Retriever	29
Chesapeake Bay Retriever	2
Irish Setter	6
Labrador Retriever	29
Lagotto Romagnolo	6
Clumber Spaniel	2
Nova Scotia Duck Tolling Retriever	7
Pointer	17
Weimaraner	7
Hungarian Vizsla	7
Gordon Setter	3
American Cocker Spaniel	2
Bracco Italiano	4
English Springer Spaniel	2
Curly Coated Retriever	1
	156
Not before 2.45pm	
GUNDOG GROUP JUDGING	

Amish Stakes	
Friday 6.30pm	
Gundogs & Utility - Ring 1 Toys & Terriers - Ring 2	
Displays	
Hounds, Working & Non-Sporting - Ring 1	
Displays	
Amish Final (Seven Group Winners)	
Total Amish	37

RING 3	
9.15am start	
Toys	
Judge - Frances Smith-Moffat	
Affenpinscher	1
Chihuahua (Smooth Coat)	8
Pomeranian	2
Chihuahua (Long Coat)	9
Havanese	5
Yorkshire Terrier	1
Griffon Bruxellois	5
Miniature Pinscher	2
Japanese Chin	11
Bichon Frise	8
Cavalier King Charles Spaniel	18
Papillon	2
Chinese Crested Dog	3
King Charles Spaniel	1
Pekingese	3
Lowchen	1
Pug	21
	101
Not before 1.30pm	
TOY GROUP JUDGING	



RING 4	
Obedience	
Test A	A1 - A20
Test B	B1 - B15
Rally-O Advanced B	AB1 - AB8
Rally-O Excellent A	EA1 - EA3
Rally-O Excellent B	EB1 - EB7

SATURDAY JUDGING

Lucky draw (approx 10.00am) - refer nds2018@dogsnz.org.nz for full information

RING 1	
9.00am start	
Working Dogs	
Judge - Dirk Spruyt	
Australian Kelpie	11
Shetland Sheepdog	21
Hungarian Puli	1
Welsh Corgi (Cardigan)	5
Welsh Corgi (Pembroke)	2
Judge - Masato Igawa	
Swedish Vallhund	3
	44
	95
Group judge - Dirk Spruyt	
Not before 10.00am	
WORKING DOG GROUP JUDGING	

Lucky Obedience draw*	
RING 4	
7.30am start	
Test C Finals	C1 - C18

Junior Dog Handler Finals
Ring 2 & 3 (8.30 start)

RING 1
Approx 11.30am
Stakes Finals
Approx 1pm start
Highlights and Displays
Followed by

The order of In Show judging may not be known until the completion of the Working Dog Group Judging

Best In Show
Puppy In Show

VENUE MAP

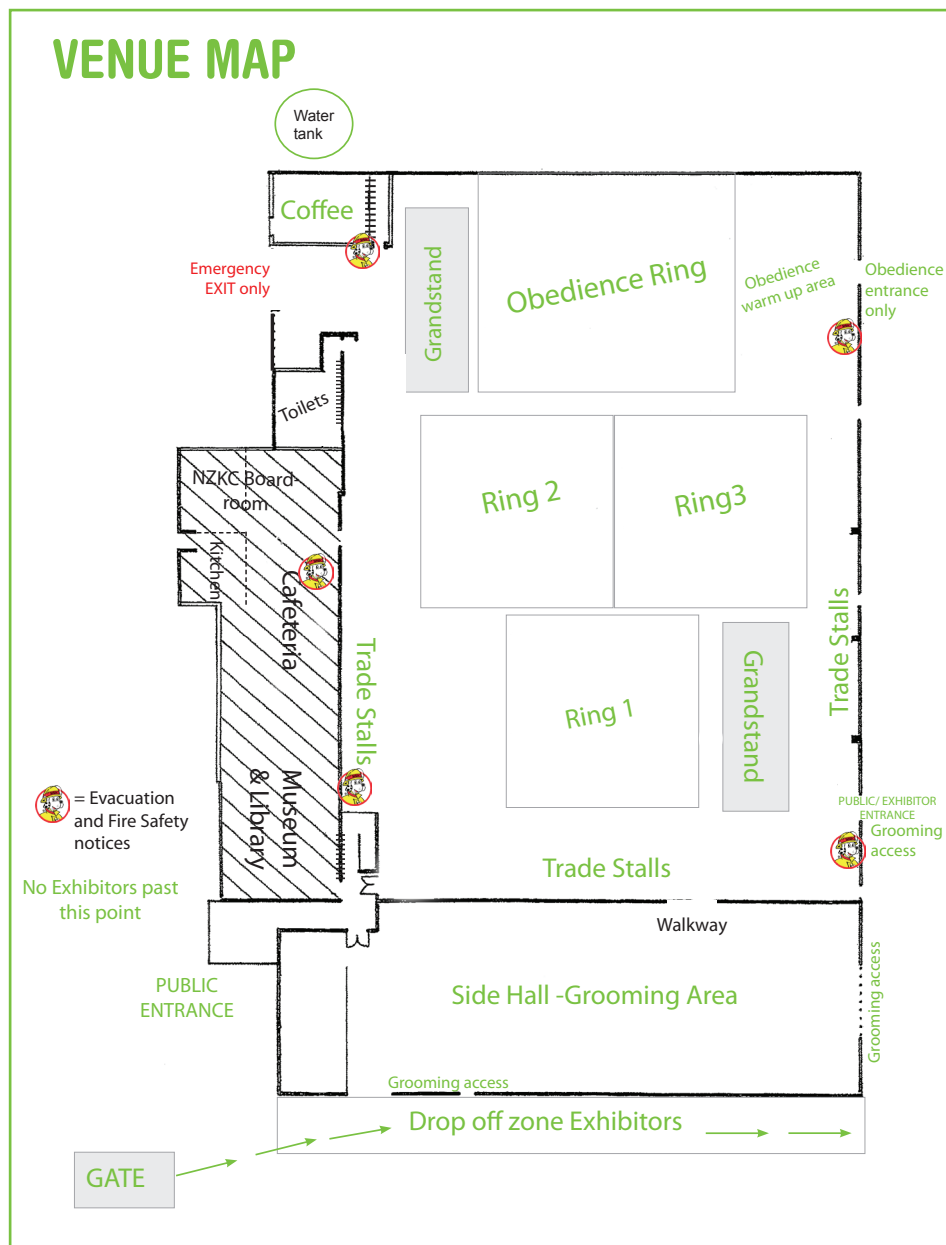

OBEDIENCE COMPETITIONS: Obedience competitors must report in at least 30 minutes prior to the start of each test. The running order will not be changed without the permission of the Test Manager. You must have a very valid reason for changing the running order.

OBEDIENCE PRIZE GIVING: Prize giving will be at the completion of each Test with each winner required at the Best In Show presentation on Saturday.

OBEDIENCE TEAM ENTRIES (CARMELE CINDY TROPHY): Entries must be in before the commencement of the first test. Entry forms will be available at the venue.

Obedience Reporting criteria is as follows:

Thursday 4th October

Obedience:

Special Beginners - course will be walked at 7:45am with judging commencing at 8:00am.

Novice will follow Special Beginners. The course will be walked 15 minutes before judging commences.

All competitors must report to the assembly steward 30 mins prior to the start of the test.

Rally-O:

Novice A and B courses will set for walking at approx 2pm. Advanced A will follow Novice B - courses will be set for walking 15 minutes before judging commences.

Friday 5th October

Obedience:

Test A - course will be walked at 7:45am with judging commencing at 8:00am.

Test B will follow Test A. The course will be walked 15 minutes before judging commences.

All competitors must report to the assembly steward 30 mins prior to the start of the test.

Rally O:

Advanced B course will set for walking at approx 2pm. Excellent A and B will follow Advanced B - courses will be set for walking 15 minutes before judging commences

Saturday 6th October

Obedience:

Test C - course will be walked at 7:15am with judging commencing at 7:30am. All competitors must report to the assembly steward 30 mins prior to the start of the test.

***LUCKY OBEDIENCE DRAW** - Enter the lucky draw to be in to win a refund of all NDS entry and grooming fees. See nds2018@dogsnz.org.nz for full details of how to enter.